

INSTRUCTION FOR INSTALLATION - Display SEG Modular - 180° connect

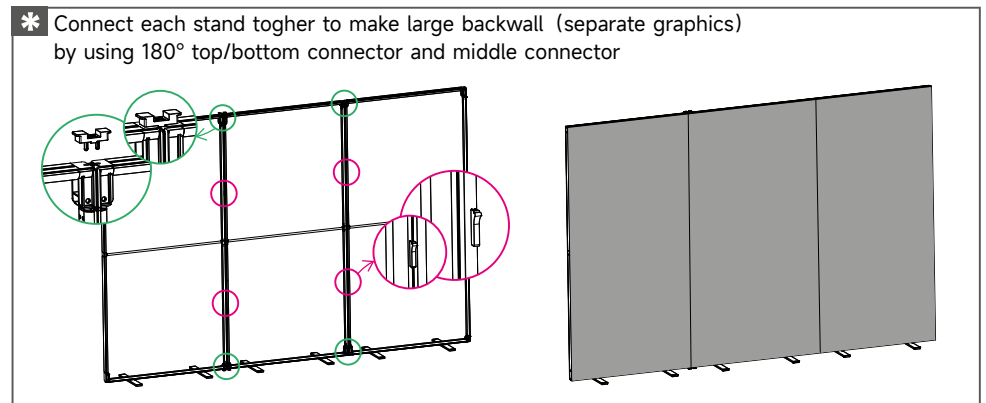
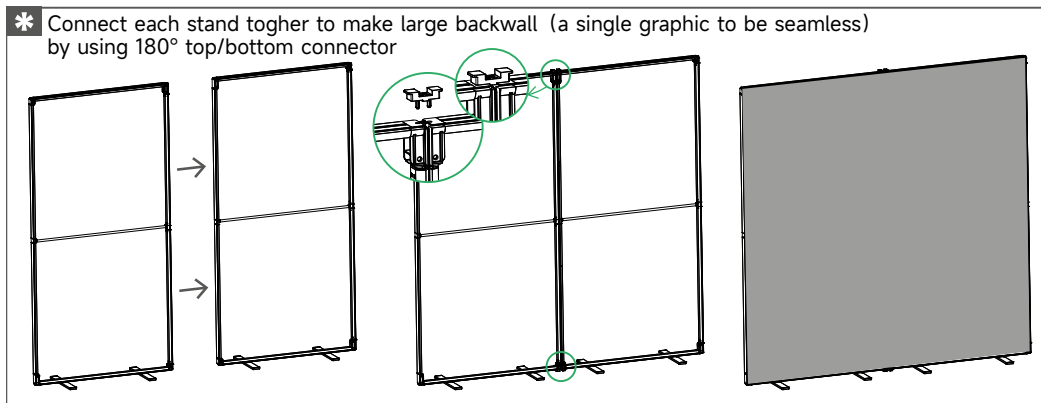
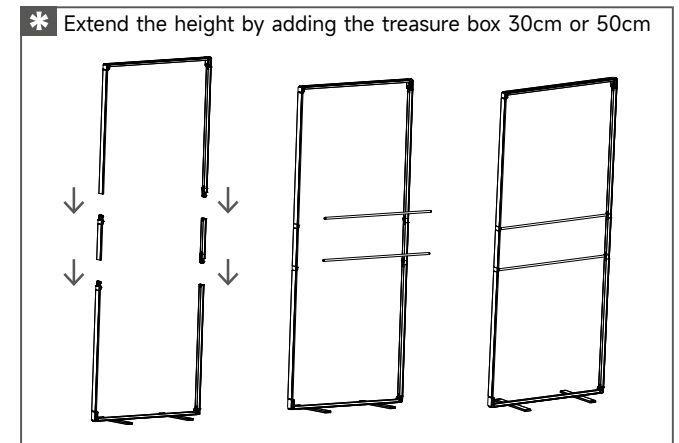
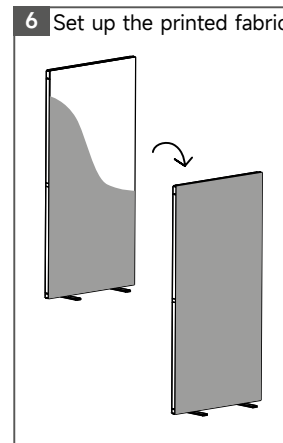
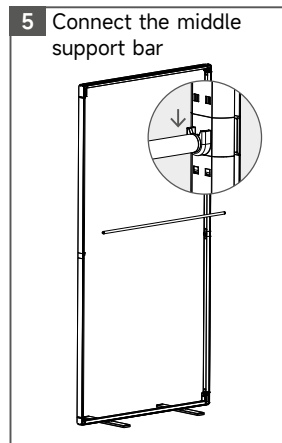
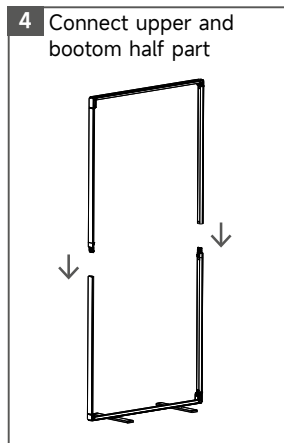
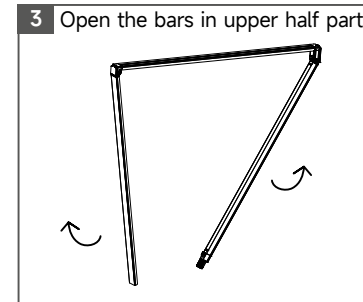
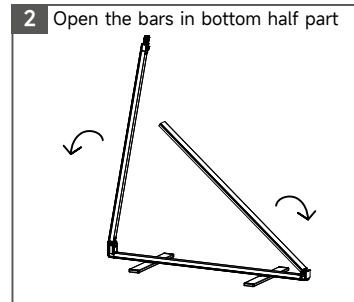
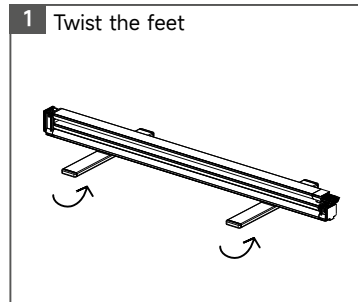
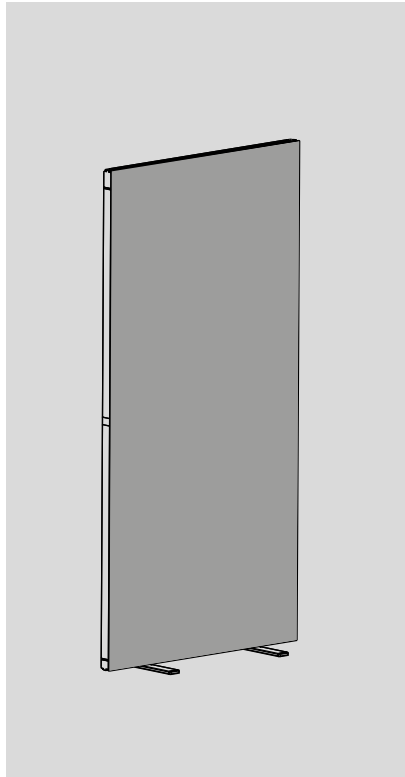

Disassemble in the reverse order.

Caution: Make sure the graphic is folded neatly and save it in bag after using, to avoid wrinkle.

INSTRUCTION FOR INSTALLATION - Display SEG Modular - 90° connect

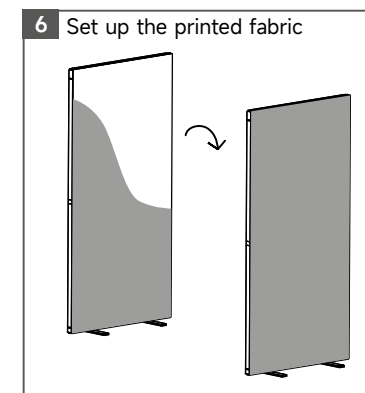
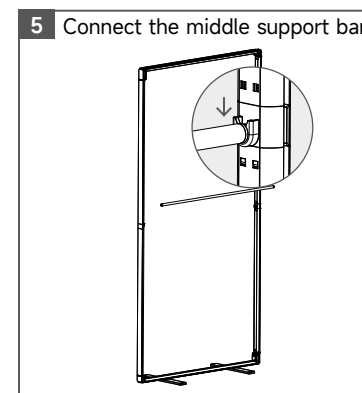
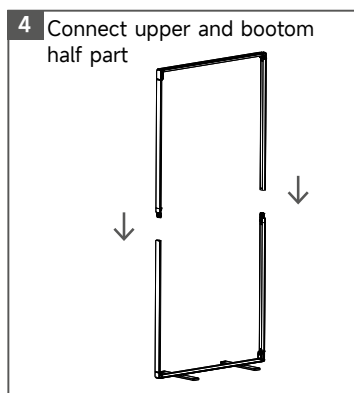
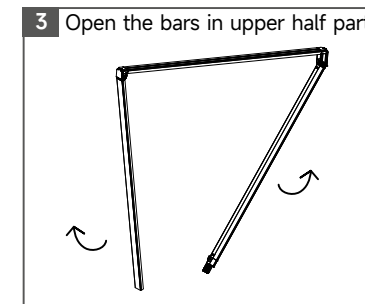
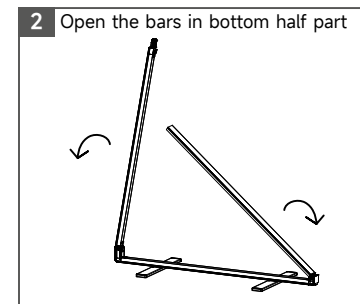
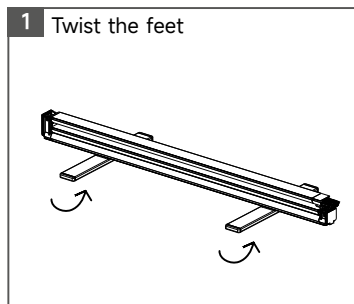
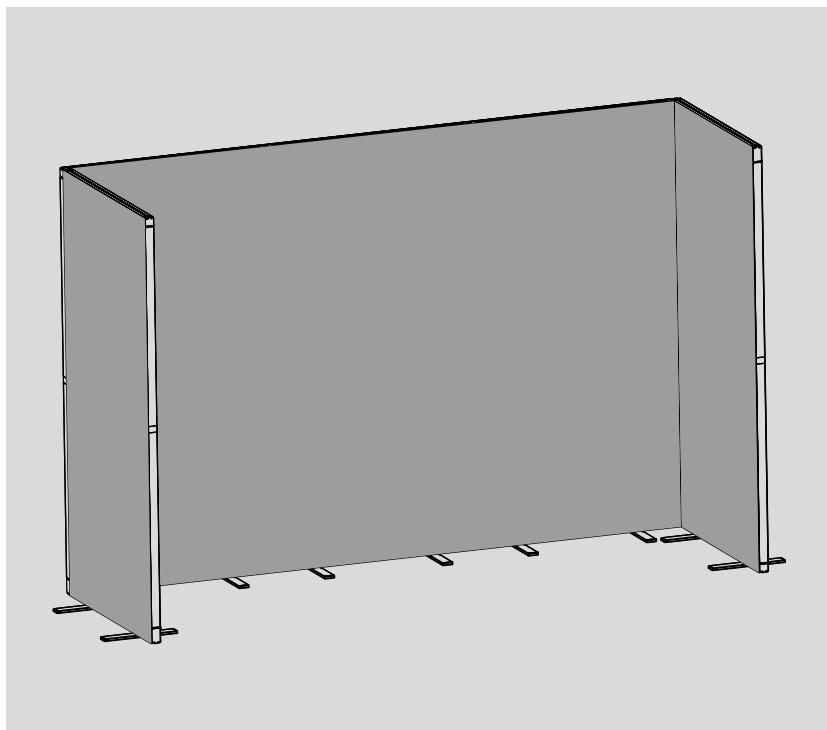

* Connect two stands by using 90° End connector L and R, 90° side connector to make V shape

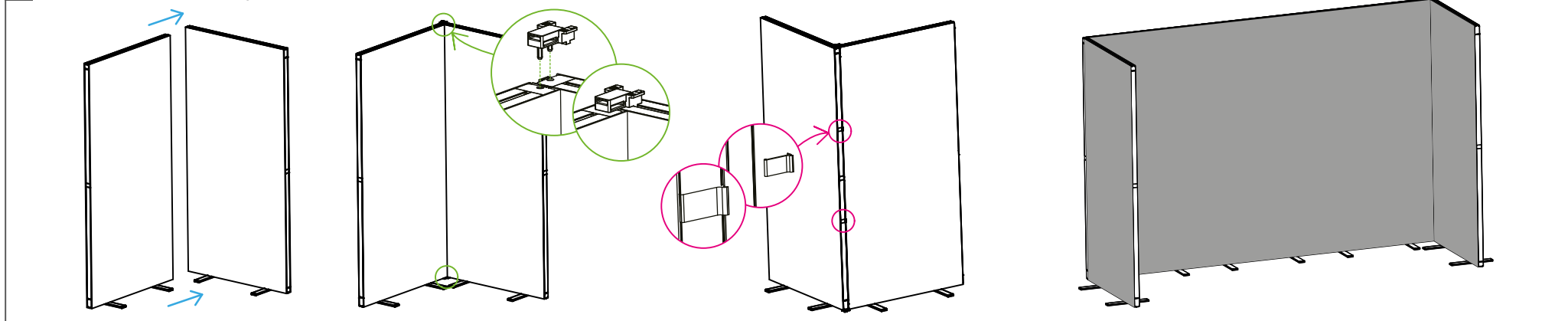

Disassemble in the reverse order.

Caution: Make sure the graphic is folded neatly and save it in bag after using, to avoid wrinkle.

INSTRUCTION FOR INSTALLATION - Display SEG Modular - Bridge connect

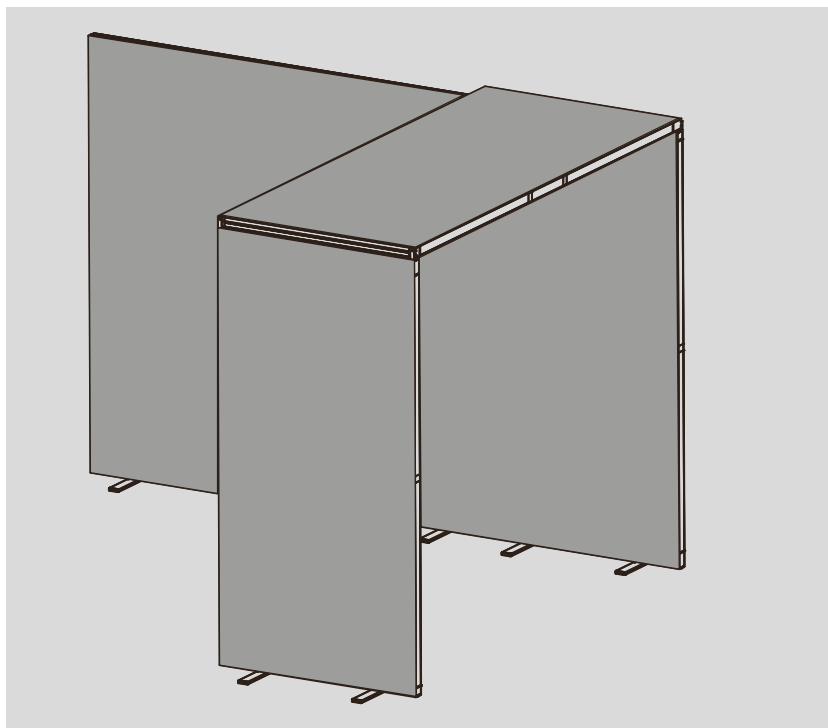

1 Open the bars in bottom half part

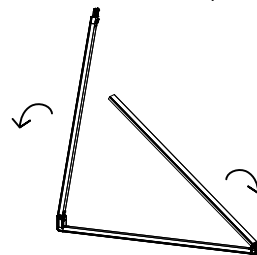

2 Open the bars in upper half part

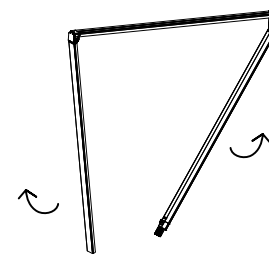

3 Connect upper and bottom half part

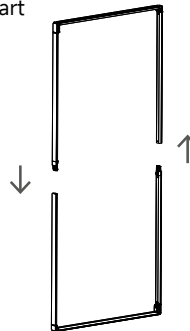

4 Connect the middle support bar

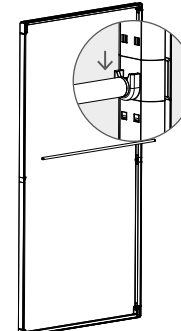

5 Set up the printed fabric

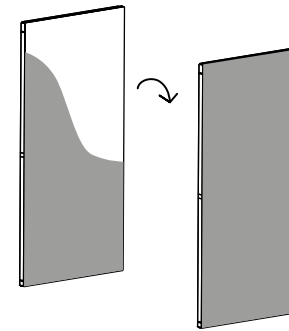

* Connect the ceiling part to make an Bridge shape

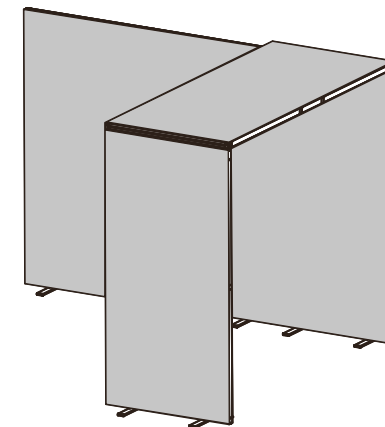
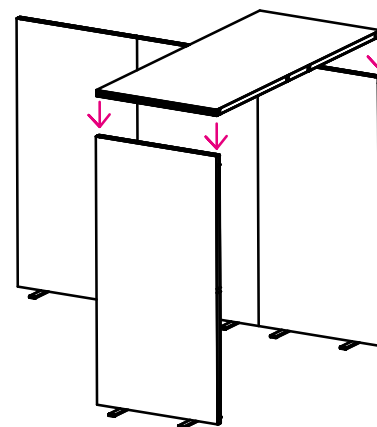
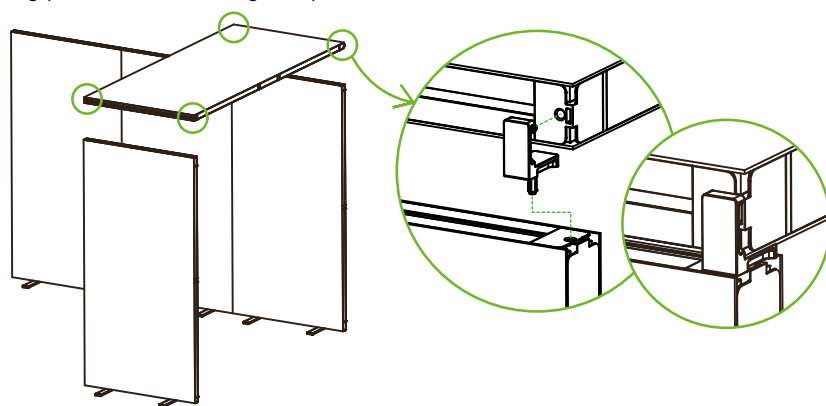

Disassemble in the reverse order.
Caution: Make sure the graphic is folded neatly and save it in bag after using, to avoid wrinkle.

INSTRUCTION FOR INSTALLATION - Display SEG Modular - Garderobe

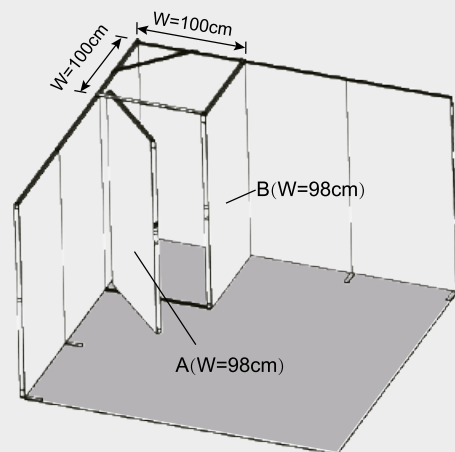

- 1** Install 100cm wide frame with T fitting (7) and 90° connector R (1) at bottom

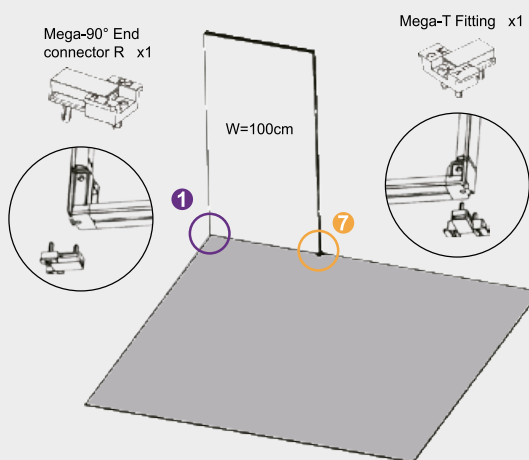

- 2** Install Panel B, insert T fitting connector and Bottom Beam

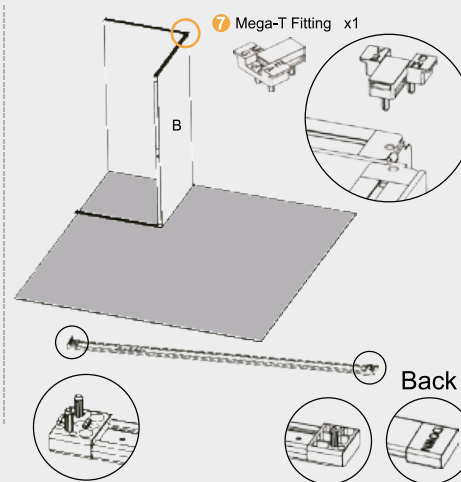

- 3** Install another 100cm wide frame by inserting into 90° connector R and bottom beam. And install the reinforced bar with screws

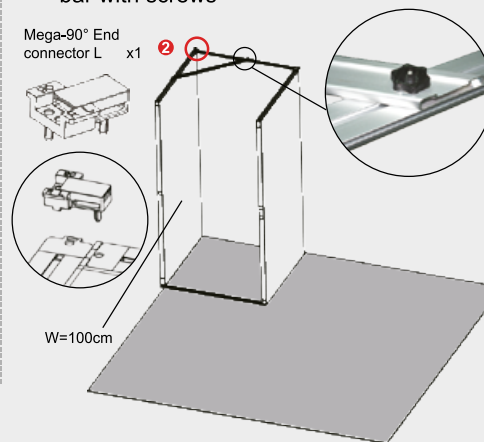

- 4** Install Panel A then install Top Beam

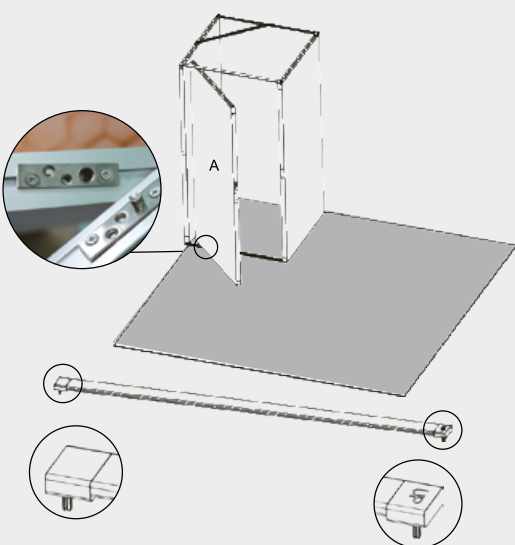

- 5** Install other frame walls

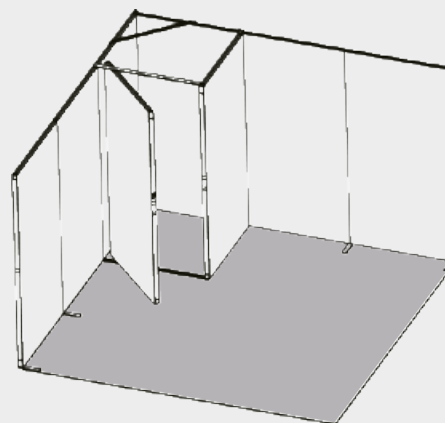

- 6** Finished overview with the door closed

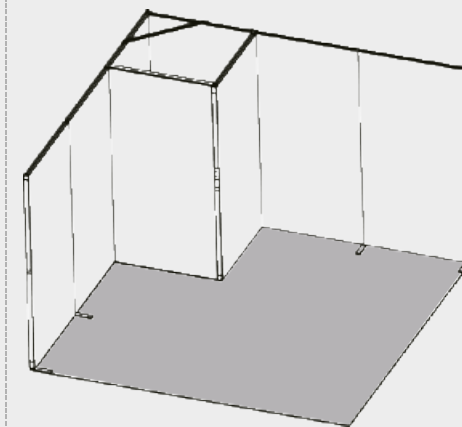

Disassemble in the reverse order.
Caution: Make sure the graphic is folded neatly and save it in bag after using, to avoid wrinkle.